

Hose Reel

Model: FIS-06-B (25mm)

Model: FIS-10-B (19mm)

Automatic & Swinging Type

Version 1.01
January 2025 release

Automatic Hose Reel

Model: FIS-06-B (25mm)
Model: FIS-10-B (19mm)

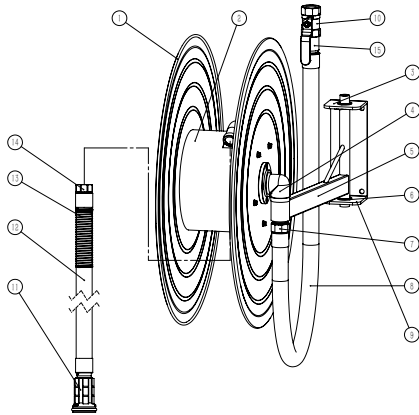

Parts Name

| No | Description |
|----|--------------------|
| 1 | Hose Reel Disc |
| 2 | Roller |
| 3 | Bracket |
| 4 | Automatic Waterway |
| 5 | Swinging Arm |
| 6 | Locking Screw |
| 7 | Inlet Joint |
| 8 | Connection Hose |
| 9 | Holder |
| 10 | Valve |
| 11 | Nozzle |
| 12 | Fire Hose |
| 13 | Spring Jacket |
| 14 | Outlet Joint |
| 15 | Connector |

Product Characteristics

| No | Description |
|----|---|
| 1 | Full brass waterway which will never rot. We use nipples not hose clamps to fill in the interface between hose and waterway. Once screwed tightly, no leakage. |
| 2 | Waterway automatic mechanism will be fully opened by no more than 3 complete revolutions of the reel. Hose reel with powder coated and anti-ultraviolet side discs. There can be pressure gauge at the reel axis. |
| 3 | High pressure resistance; working at 30kg pressure but not affected. |
| 4 | Endurance test on reel rotation; after over 3000 rotations, hose reels show no visible leakage. Our swinging hose reels are able to swing 1000 times to minimum 170° and show no visible leakage or damage. |
| 5 | High pressure spray. The nozzle can be adjusted to jet/spray. |
| 6 | Our hose reels can be also used for cleaning when used for fire fighting. |
| 7 | Fire hose with anti-aging and anti-ultraviolet function. Maximum WP is 12Bar. Average BP can be up to 45Bar. |

Product Specification & Installation Measurement

| Model | Hose Specification (mm) | Diameter (mm) | Bracket Length (mm) | Reel Width (mm) | Remarks |
|----------|-------------------------|---------------|---------------------|-----------------|-------------------------|
| FIS-06-B | 25mm x 20m / 30m | 600 / 555 | 300 | 150 / 180 | Pressure Gauge Optional |
| FIS-10-B | 19mm x 20m / 30m | 555 | 280 | 150 | Pressure Gauge Optional |

Usage

| | |
|---|---|
| 1 | According to the indication on hose reel, spin the reel ① 2-3 rotations to "ON" direction. The automatic waterway ④ will be open. Then pull hose towards fire, open nozzle to spray/jet and aim hose at fire. |
| 2 | After use, rewind the hose in "OFF" direction on hose reel. |



Gate 2, Aljada Logistics Area,
Behind Arada Project Management
Office, Near Airport Road,
Muweilah, 22436, Sharjah

rhinotek.ae